



A LEADING MANUFACTURER OF
GAS DETECTOR & IR THERMOMETER
MONITORING TEMPERATURE AND GASES.



Suction Type
Gas Detector



Gas Detector



Gas Detector Receiver

Smoke Sensor



Fire Prevention &
Detection System

Infrared Thermometer



COMPANY HISTORY

- 2022**
 - Acquired the EC Certification for gas analyzer (DA- 770)
 - Acquired the KFI type Certification (Ga 22-46)
 - Acquired domestic explosion-proof indicator Certification (GMS-1600)
- 2021**
 - Acquired infrared thermometer CE Certification (IR-22)
 - Acquired the Smoke detector CE Certification (ASD-55, 56, 57)
- 2020**
 - Registered at a KOLAS Accreditation Calibration Institution
 - Registered a patent for fire prevention detector (MIR-64, MDI-64)
 - Developed an optical oxygen analyzer (DA-770-O2)
- 2019**
 - Moved to a new office building (Incheon)
 - Acquired the gas alarm type approval (Ga 19-5, A 19-9)
- 2018**
 - Acquired the CE (COC) Certification for gas alarm receiver (GMS-2500)
 - Acquired the dust explosion-proof certificate from domestic explosion-proof safety for product (Gas Detector DA- 800)
- 2017**
 - Acquired the gas alarm type certification (Ga 17-1)
 - Developed Pyrolyzer Module (NF3, SF6, WF6)
 - Developed Power Over Ethernet (PoE) Webpage
- 2016**
 - Acquired international explosion proof certification ATEX, IECEx for DA-100
 - Developed Suction type Analyzer N20
- 2015**
 - Acquired KR (Korean Register Shipping Certification)
 - Developed Infrared Rays Thermometer for Glass (GLASS-5.2)
 - Developed oxygen analyzer of Zirconia sensor (DA-60)
 - Developed IR-Brazing Thermometer for Brazing (Brazing-3.9)
- 2014**
 - Developed View type Infrared thermometer (IR-VIEW)
 - Developed compact Infrared thermometer (IR-compact, IR-22)
 - Developed Thermal + Smoke Detector (TS-60)
- 2013**
 - Developed two color Pyrometer (SS-100, 2IGA-100)
- 2012**
 - Develops the wireless environment instrument IAQ-700
 - Registers a patent for infrared thermometer
- 2011**
 - Selected as a promising small and medium-sized business in Incheon
 - Developed Korea's first low-concentration O2 analyzer (0~10000ppm)
- 2010**
 - Acquired Thailand, Malaysia agency contract
- 2009**
 - Developed Korea's first low-temperature and high-temperature infrared thermometers (IR-20, IR-80)
 - Developed Korea's first mini-infrared thermometer (IRman Series)
- 2008**
 - Developed infrared gas analyzer (CH4, CO2, N2O, H2)
- 2007**
 - Developed the suction type gas detector (DA-750, DA-800)
 - Establishment of Research & Development Centre
- 2006**
 - Smoke sensor utility model and design registration
- 2005**
 - Developed smart gas detector
 - Developed single/multi-channel gas receiver
- 2004**
 - Established Gas DNA Co., Ltdl
 - Developed the first non-visible display gas detector

GasDNA Co.,Ltd is a professional and leading manufacturer of fixed Infrared thermometers, Gas detectors and smoke detectors for factory automation and process control in industry. GASDNA is focusing on developing and distributing more convenient and stable gas detectors and infrared thermometers.

Based on the technologies and expertise accumulated Since 2004, we have positioned as Korea's only infrared thermometer manufacturer, and we are planning to expand into not only the domestic market but overseas markets. We develop and manufacture efficient and reliable products based on state of the art technologies, and we do our best to be the world leading company in the gas detector and Infrared thermometer field.

GasDNA promise customer's safety and product quality in accordance with the quality assurance K mark and ISO9001 quality system to maximize the customer's use value.

GasDna Co.,Ltd

C.E.O Go sung woon

CONTENTS

Smart Gas Detector

DA-600 Series	4
DA-500 Series	4
DA-100 Series	5
DA-800 Series	5
DA-750,DA752 Series	6

Gas Analyzer

DA-770,DA-790	7
---------------	---

Battery Leak Detector

BLD-1000	8
----------	---

Smart gas Detector

DA-50 Series	9
DA-90-10 Series	9

Gas Detector Receive

GMS-1700	10
GMS-1000	10
GMS-1550	11
GMS-2500	11

Standard Gas

Gas List	12
Cylinder,Regulator	13

Fire Prevention Detector

MIR-64	14
MDI-i,MDI-64	15

Smoke Detector

ASD-55,ASD-56,ASD-57	16
----------------------	----

Temperature & Smoke Detector

TS-60,TS-70	17
-------------	----

Fixed IR thermometers

IR-100	18
IR-90	18
IR-View	19
4-IRman	19
IR-22	20
IR-Compact	20
IR-40	21
Thermometer Accessories	21

Indicator

DA-90	22
IR-I	22
GMS-1600	23

Portable IR Thermometer

PIR-80	24
PIR-1500	24
PIR-550	24

Leak Sensor

LD-20	25
-------	----

Certifications	26~27
-----------------------	-------



Gas Detector



Digital Controller



Standard Gas



Smoke Sensor



Smoke Sensor



Fixed Infrared Thermometer



Portable Infrared Thermometer



Multi-input Indicator



Wireless Indoor Air Quality Monitor

SMART Gas Detector

DA-600 Series

Non-Indicator type,
Explosion proof



* Dimension

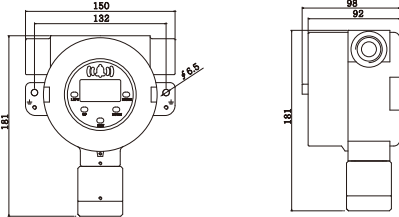

DA-500 Series

Indicator type,
Explosion proof



*options

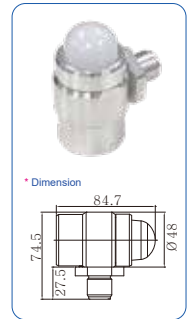

* Dimension

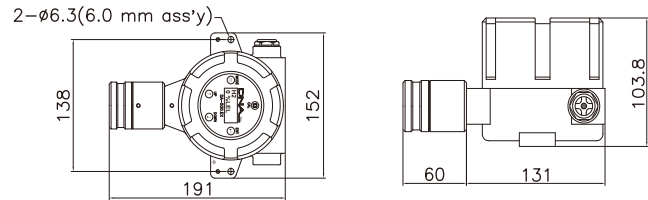

► Product Specification

Model no.	DA-600
Detection Method	Diffusion
Detection Principle	Catalytic combustion, Non-dispersive infrared (NDIR), TCD, Electro-chemical
Display	OLED 64x128 pixels
Explosion Protection	Explosion Proof
Gas groups	11A, 11B, 11C
Response speed & Accuracy	Within 20sec, 90%, full scale, ≤±2 % / full scale
Optional Function	Calibration concentration, detection range setting
Measurement range	Refer the Gas list on page 12
Input Power	DC 20~30V, 100mA
External Output	4 ~ 20mA/Full Scale - 2.5km transmission
Detector Output	CVVS & CVVSB 1.5sq x 3 Wire - Shield Type
Ambient Temperatures & Humidity Range	4-20 mA source or sink selectable/2mA = Fault 4-20 mA = Normal gas range/24 mA = Over range
Signal Wire	CVVS & CVVSB 1.5sq x 3 wire - shield type
Wire Conduit	3/4" NPT or 1/2" PF
Installation Method & External Material	Wall or Pipe Mounting, Cast Aluminum Alloy
Explosion Proof approval & IP rating	Ex d IIC T6(IP66), Ex Td A21 T85°C IP66 (KC) EU-TYPE Examination Certificate (ATEX) IECEX Certificate of Conformity (IECEX)
Relay Output	2 Step-Relay Contact / ALARM-1 relay SPNO / ALARM-2 relay SPNO
Communication Output (Optional)	Modbus RTU based on RS-485, HART Communication
Zones	Certified for use in Zone 1 or Zone 2 areas. (See area classifications section)
Dimension	150x181x98(mm)
Weight	2200g

► Product Specification

Model no.	DA-500
Detection Principle	Catalytic combustion, Non-dispersive infrared (NDIR), TCD, Electro-chemical
Detection Method	Diffusion type
Target Gas	Combustible gas, Toxic gas
Detection Range	0~100% LEL, 0~10,000 PPM, 0~100% VOL
Response Time	Within 30sec, 90%/full scale
Accuracy	≤±2%/full scale
Display	Back Light LCD(2 Line - 8 Characters)
Checking Function	Sensor fault indication on LCD (SEN -err), 2mA Output
Selection Function	Calibration concentration, Detection range setting
Input Power	DC 20 ~ 30V
External Output	4mA~20mA / Full scale - 2.5Km Transmission
Operating Temperature/ Humidity	-30°C~60°C, 5~95% RH (Non-Condensing)
Signal Cable	CVVS & CVVSB 1.5sq x 3 Wire - Shield Type
Cable Conduit	1/2" or 3/4" PF, NPT
Installation Method	Wall or Pipe Station
External Material	Cast Aluminum Alloy
Explosion-Proof Approval	Ex d IIC T5 - KGS
Relay contacts	2 step-Relay Contact (High/Low), RS-485

SMART Gas Detector



DA-100 Series

Non-display
SMART Gas Detector



* Dimension

2- ϕ 6.3(6.0 mm Ass.y)

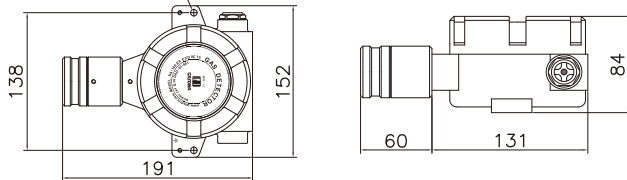

DA-800 Series

Suction Tybe
SMART Gas Detector



* Dimension

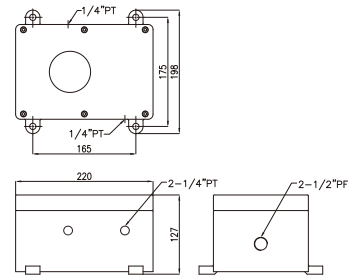

► Product Specification

Model no.	DA-100
Detection Principle	Catalytic combustion, Electro-chemical
Detection Method	Diffusion type
Target Gas	Combustible gas, Toxic gas
Detection Range	0~100% LEL, 0~10,000 PPM, 0~100% VOL
Response Time	Within 20sec, 90%/full scale
Accuracy	$\leq \pm 2\%$ /full scale
Checking Function	Sensor fault indication on FND (S-err), 2mA Output
Input Power	DC 20 ~ 30V
External Output	4mA~20mA / Full scale - 2.5Km Transmission
Operating Temperature/ Humidity	-30 $^{\circ}$ C~60 $^{\circ}$ C, 5~95% RH (Non-Condensing)
Signal Cable	CVVS & CVVSB 1.5sq x 3 Wire - Shield Type
Cable Conduit	1/2" or 3/4" PF, NPT
Installation Method	Wall or Pipe Station
External Material	Cast Aluminum Alloy
Explosion-Proof Approval	Ex d IIC T5 - KGS

► Product Specification

Model no.	DA-800
Detection Principle	Catalytic, NDIR, TCD, Electro-chemical, PID
Detection Method	Suction type
Target Gas	Combustible gas, Toxic gas, O ₂ , VOC
Detection Range	0~100% LEL, 0~100% VOL, 0~10,000 PPM
Response Time	Within 10sec, 90%/full scale
Accuracy	$\leq \pm 2\%$ /full scale
Induced Vacuum Flow	0.2 l/min ~ 2.5 l/min
Checking Function	Auto - Calibration With Magnetic Switch
Select ion Function	Calibration concentration, Detection-range setting
Input Power	DC 20 ~ 30V
External Output	4mA~20mA / Full scale - 2.5Km Transmission
Operating Temperature /Humidity	-20 $^{\circ}$ C~60 $^{\circ}$ C, 5%~95% RH (Non-condensing)
Signal Cable	CVVS & CVVSB 1.5 sq x 3Wire shielded type
Cable Conduit	1/2" or 3/4" PF, NPT
Installation Method	Wall Mounting Type
External Material	Cast Aluminum Alloy
Explosion-Proof Approval	Ex d IIB+H2 T6- Korea Gas Safety Corporation (KGS)
Relay Contacts	2 Step Relay-Contact (High/Low), RS-485
Suction Line Conduit Pipe	1/4" Tube

SMART Gas Detector

DA-750 Series

Suction Type
SMART Gas Detector



* Dimension

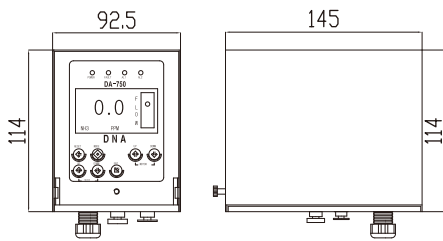

DA-752 Series

Suction Type
SMART Gas Detector



* Dimension

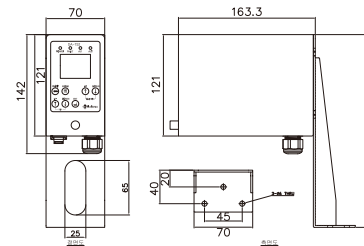

► Product Specification

Model no.	DA-750
Detection Method	Suction Type
Detection Principle	Catalytic combustion, Non-dispersive infrared (NDIR), TCD, Electro-chemical
Display	LCD Display
Measuring Method	Suction Type
Sucking Capacity	1.5 L/min~2.5 L/min
Alarm Signal	LOW LED (RED) HIGH LED (RED)
Response speed & Accuracy	Within 0- 90sec, $\leq \pm 3\%$ /full scale
Measurement Range	Refer the Gas list Section below
Input Power	DC 20~30V
Output Signal	4 ~ 20mA DC/ F.S
Detector Output	4-20 mA source or sink selectable 2mA = Fault 4-20 mA = Normal gas range 24 mA = Over range
Alarm Reset	Manual and Auto Reset
Ambient Temperatures & Humidity Range	-10°C ~ 50°C, 5 ~ 95% RH (Non-condensing)
Signal Wire	CVVS & CVVSB 1.25sq x 3 wire-shield Type
Installation Method	Wall Mounting Type

► Product Specification

Model no.	DA-752
Detection Method	Suction Type
Detection Principle	Electrochemical, Catalytic, TCD, NDIR
Input Power	DC24V
Sucking Capacity	0.5 lt-2.5 Lt/min
Output Signal	4~20mA DC/F.S
Response Speed & Accuracy	Within 25sec, 90%, full scale, $\leq \pm 3\%$ / full scale
Concentration Display	1.7" TFT Display - PPM, %LEL, % User can Set as per requirement
Input Power	DC 18~30V
Alarm Delay Time	0~99 seconds user-settable
Alarm Display	Alarm 1- AL1 LED (RED) Alarm 2- AL2 LED (RED)
Alarm Value Setting	Two stage relay Alarm AL1/AL2- User can set as per requirement
Ambient Temperatures & Humidity Range	-10°C ~ 50°C, 5 ~ 95% RH (Non-condensing)
Signal Wire	CVVS & CVVSB 1.25sq x 3 wire-shield Type
Alarm Off	Manual and Automatic return
Relay Output	2 Step- Relay Contact ALARM-1 relay SPNO ALARM-2 relay SPNO
Wire Conduit	Teflon 1/4"
Installation Method	Wall Mounting Type
Communication Output (Optional)	RS-485

Gas Analyzer



DA-770

Suction Tybe
Gas Analyzer

DA-790

Suction Tybe
Gas Analyzer

CE



* Dimension

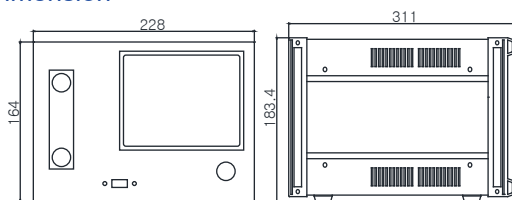

* Dimension

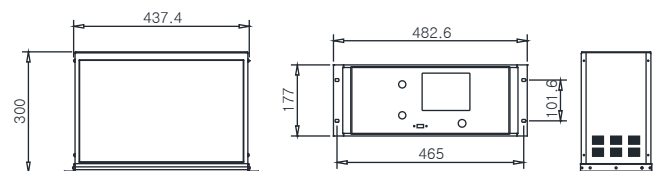

► Gas Type & Measurement principle

Gas Name	Measurement Range	Measurement principle
CO ₂	0~100 PPM, 500 PPM, 1000 PPM, 5000 PPM, 10000 PPM 0~2 %VOL, 0~5 %VOL, 0~20 %VOL, 0~50 %VOL, 0~100 %VOL	NDIR
CO	0~2000 PPM, 0~5 %VOL, 0~20 %VOL, 0~50 %VOL, 0~100 %VOL	NDIR
CH ₄	0~5000 PPM, 0~5 %VOL, 0~50 %VOL, 0~100 %VOL	NDIR
SF ₆	0~50 PPM, 0~2000 PPM, 0~5000 PPM, 0~100 %VOL	NDIR
SO ₂	0~2000 PPM	NDIR
SO ₂ FS	0~100 PPM, 0~4 %VOL	NDIR
CH ₃ Br	0~5.8 %VOL	NDIR
N ₂ O	0~500 PPM, 0~2000 PPM, 0~10 %VOL	NDIR
TEOS	0~2000 PPM	NDIR
CH ₂ F ₂	0~2000 PPM	NDIR
O ₂	0~1000 PPM, 0~100 %VOL	Optical
NO	0~300 PPM	NDUV
NH ₃	0~100 PPM	TDLS
H ₂	0~2 %VOL, 0~5 %VOL, 0~50 %VOL, 0~100 %VOL, 90~100 %VOL	TCD



Battery Leak Detector

BLD-1000

Battery Leak Detector



* Dimension

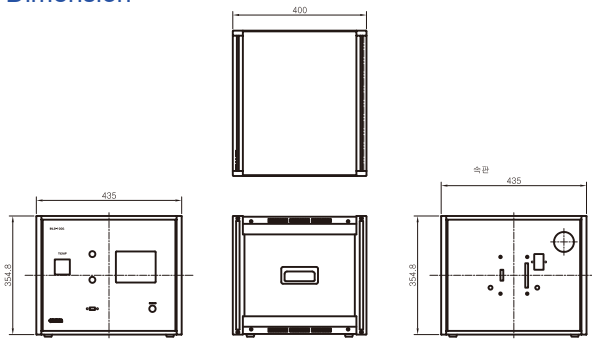

▶ Product Specification

Model no.	BLD-1000
Detection Method	Auto suction
Detection Principle	NDIR
Detection Range	0~100 PPM
Resolution	0.1 PPM
Warm-up time	<30 Minutes
Power	AC220V/60Hz
Output	DC 4-20mA Rs-485 Mode bus
Alarm	0.5A/125V Relay contact (SPST)
Alarm Value	AL1, AL2, Fault
Response Time	<7sec
Accuracy	±1%
Sampling Line	6∅
Capacity	0~2.5 liter/Min
Signal Wire	1.5SQ*3wire
Operating Temp	-20~60℃
Humidity	5~95%R.H.(not condensing)
Display	7" TFT LCD Korean manual or English manual
Size	435(W)*355(H)*400(D)

SMART Gas Detector



DA-50 Series

Indicator type
Smart Gas Detector

CE



* Dimension

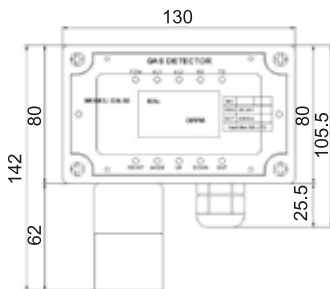

DA-90-10 Series

Waterproof type
Smart Gas Detector



* Dimension

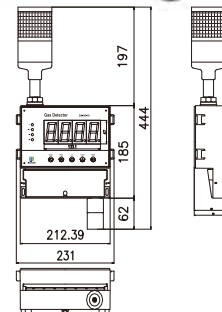

Product Specification

Model no.	DA-50
Detection Principle	Catalytic, Electrochemical, Non-dispersive-infrared (NDIR), Photo-ionization (PID)
Detection Method	Diffusion Type
Target Gas	Combustible gas, Toxic gas
Accuracy	≤±2%/full scale
Input Power	DC 20V~30V (24V DC Normal) / 100mA (Max.)
External Output	4mA~20mA, 2Step Relay (AL1, AL2) RS-485
Relay Outputs	250 V 0.6 A / 2-SPST Relay-Contact (2 Alarms)
Display	LCD(8Characters*2Line) With Back-light %,PPM,PPb
Operating Display	4 LEDs (Power, 2 Alarms, 2-RS485 TX, RX)
Signal Cable	CVVS & CVVSB 1.5 sq *3Wire shielded type
Operating Temperature / Humidity	-20 °C ~ 50 °C, 5% ~ 90% RH (Non-condensing)
Installation Method	Wall Mounting Type
Housing	Polycarbonate
Sensor calibration	Calibration with Switch
User programmable	Calibration Density, Detection Range

Product Specification

Model no.	DA-90-10
Detection Principle	Electrochemical
Detection Principle	Diffusion Type
Response time	Within 10sec 90%/Full Scale
Target Gas	CO (0~1000ppm)
Accuracy	≤±2%/Full Scale
Selectable Function	Calibration density, Detection range setting
Input Power	AC 220V/60Hz
Output Power	4~20mA/Full Scale - 2.5Km Transmission
Alarm	Low alarm - AL1 LED(RED)
	High alarm - AL2 LED(RED)
	Light bar - BZ LED(RED)
Alarm method	Sight - Light bar
	Hearing - Buzzer (90dB/1m)
Operation Temperature / Humidity	-20°C~60°C, 5~95% RH (Non-Condensing)
Alarm Off	Manual and automatic release
Alarm Output	2 step (AL1/AL2) alarm relay contact, RS-485 (option)
Installation Method	Wall Mounting Type

Gas Detector Receiver

GMS-1700

Single-Point
Gas detector Receiver



* Dimension

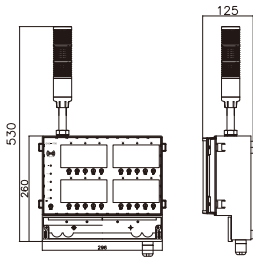

▶ Product Specification

Model no.	GMS-1700
Installation Method	Wall-mounted
Control Structure	Alarm UNIT: 1, Receive Unit: 4
Detector Connection Type	For multi-point type (4 connected detectors)/4 circuit
Input Power	AC100~240V/60Hz
Battery Power	DC24V 2.5AH
Input Signal	4-20mA DC/F.S
Output Signal	4-20mA DC/F.S
Out Voltage	24 V (5 A)
Alarm Signal	Low Alarm - AL1 (RED) High Alarm - AL2 (RED) Failure alarm - FAULT LED (YELLOW)
Alarm Method	Time - LED blinking / Hearing - Buzz Bass (over 80dB)
Alarm Value Setting	AL1, AL2 2-stage alarm-user arbitrarily set
Alarm Delay Time	0~99 sec user arbitrarily set
Clear Alarm	Manual and automatic return
Alarm Output	2-stage (AL1, AL2) alarm RELAY CONTACT
Operating Temperature	-10℃ ~50℃
Operating Humidity	5~95%RH (Non-Condensing)
Display	3 color 1.8 inch 3 - Digit 7 Segment. Normal(Green), AL1(Orange), AL2(Red) ※ Blinking

GMS-1000

Single-Channel Digital
Controller of Gas detector



* Dimension

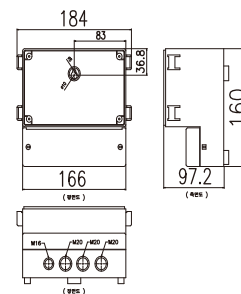

▶ Product Specification

Model no.	GMS-1000
Structure	Single type / 1 Circuit
Input Power	AC 230V / 60Hz
Input Signal	4~20mA DC / Full scale
Output Power	DC 24V(250mA)
Output Signal	4~20mA DC / Full scale
Signal Resolution	A/D Converter - ±20000 D/A Converter - 12bit
Display	%LEL (Combustible), % (Oxygen), PPM (Toxic)
Alarm Display	Low alarm - AL1 LED (Red) High alarm - AL2 LED (Red) Fault alarm - Fault LED (Yellow)
Alarm Type	Visual : LED flickering Auditory : Buzzer sound (More than 80 dB)
Alarm Density	AL1 / AL2 2 Level alarm density (Adjustable by user programming by user)
Alarm Delay Time	0 sec ~ 99 sec (Adjustable by user programming by user)
Alarm Off	Manual , Automatic return
Alarm Output	2 step (AL1 / AL2) Relay-Contact
Operating Temperature	-20 ℃ ~ 50 ℃
Operating Humidity	5% ~ 95% RH (Non-condensing)
External Material	Poly Carbonate (P.C)
Installation Method	Wall Mounting
Option	Light Bar

Gas Detector Receive

GMS-1550

Four-Point
Gas detector Receiver



* Dimension

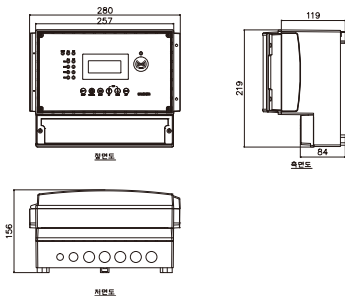

GMS-2500

Multi-Channel Digital
controller of Gas detector



* Dimension

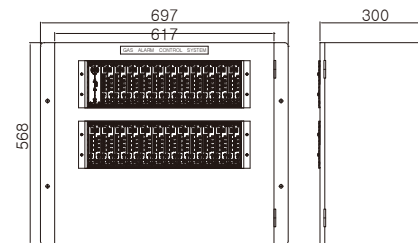

▶ Product Specification

Model no.	GMS-1550
Product	Wall-mounted
Connection Type	Multi Points 4 Gas Detector units/ 4 Circuits
Input Power	AC 100~240V/60Hz
Reserve Power	DC24V Lithium Ion Battery(Optional)
Battery	DC24V 2.5AH
Input Signal	4-20mA DC/F.S
Output Power	DC 24V(250mA)
Output Signal	4-20mA DC/F.S
Display	LCD Display - PPM, %LEL, % user arbitrarily set
Alarm Signal	Low Alarm - AL1 (RED) High Alarm - AL2 (RED) Failure alarm - FAULT LED (YELLOW)
Alarm Method	Time - LED Blinking Hearing - Buzz Bass (over 80dB)
Alarm Value Setting	AL1, AL2 2-stage alarm-user arbitrarily set
Alarm Delay Time	0~99 sec user arbitrarily set
Alarm Off	Manual and automatic Reset
Alarm Output	2-stage (AL1, AL2) alarm RELAY CONTACT
Operating Temperature	-10℃ ~ 50℃
Operating Humidity	5 ~ 95%RH (Non-Condensing)

▶ Product Specification

Model no.	GMS-2500	
	Power & Alarm Unit	Receiving Unit
Control Structure	Alarm unit : Receiving unit = 1:1 ~ 64	Receiving unit : detector = 1:1
Extension Structure	Slide Card Type	
Input Power	AC 230V / 60Hz	
Input Signal	4~20mA DC / F.S	
Output Power	DC 24V (250mA)	
Output Signal	4 ~ 20mA DC / F.S , RS-485(Optional)	
Display	% LEL (Combustible), % (Oxygen), PPM (Toxic)	
Power Display	Power LED (Green)	
Alarm Display	Alarm LED (Red) Alarm LED flickering	Low alarm - AL1 LED (Yellow) High alarm - AL2 LED (Red) Fault alarm - Fault LED (Red)
Alarm Type	Buzzer sound (More than 90 dB)	Visual : Applicable alarm LED Flickering
Alarm Density		High / Low - 2Level alarm density (Adjustable by user)
Alarm Delay Time		0 ~ 99 sec (Adjustable by user)
Alarm Off	Manual, Automatic return	
Alarm Output	SPDT Relay output for High / Low 2Level alarm SPDT Relay output for Fault alarm	
Operating Temperature / Humidity	-20℃~50℃, 5~95%RH (Non-Condensing)	
External Material	19" (3U) Unit : Aluminum / System enclosure: Metal case	
Output Option	RS-485	
Option	Light Bar	

► **Combustible Gas Detection**

Target Gas	Molecular Formula	Target Gas	Molecular Formula
Acetaldehyde	CH ₃ CHO	Iso-butane	i-C ₄ H ₁₀
Acetic acid	CH ₃ COOH	Iso-propyl alcohol	(CH ₃) ₂ CHOH
Acetone	CH ₃ COOH ₃	Methane	CH ₄
Acetylene	C ₂ H ₂	Methyl alcohol	CH ₄ O
Benzene	C ₆ H ₆	Methyl bromide	CH ₃ Br
Butane	C ₄ H ₁₀	Naphthalene	C ₁₀ H ₈
Chloro benzene	C ₆ H ₅ Cl	Octane	CH ₃ (CH ₂) ₆ CH ₃
Chloro benzene	C ₆ H ₁₂	Pentane	CH ₃ CH ₂ CH ₂ CH ₃
Di-Methylethar	CH ₃ OCH ₃	Phenol	C ₆ H ₅ OH
Ethane	C ₂ H ₆	Propane	C ₃ H ₈
Ethanol	CH ₃ CH ₂ OH	Propylene	C ₃ H ₆
Ethylene	C ₂ H ₄	Propylene oxide (PO)	C ₃ H ₆ O
Ethylene glycol (EG)	HOCH ₂ CH ₂ OH	Thinners	
Ethylene oxide (EO)	C ₂ H ₄ O	Toluene	C ₇ H ₈
Formic acid	CH ₂ O ₂	Vinyl acetate (VAM)	CH ₂ =CHOCOCH ₃
Gasoline		Vinyl chloride	CH ₂ =CHCl
Heptane	CH ₃ (CH ₂) ₅ CH ₃	Xylene	C ₈ H ₁₀ =C ₆ H ₄ [CH ₃] ₂

※ For other gases, Please inquire with us.

► **Target Gas Detection**

Target Gas	Molecular Formula	Range	DA-600	DA-500	DA-100	DA-800	DA-750	DA-752
Acetylene	C ₂ H ₂	0~10.0 PPM	●	●	●	●	●	●
Ammonia	NH ₃	0 - 100 ppm	●	●	●	●	●	●
Argon	Ar	0~100% VOL	●	●	●	●	●	●
Arsine	AsH ₃	0 - 3.0 ppm	●	●	●	●	●	●
Boron Trichloride	BCl ₃	0 - 10.0 ppm	●	●	●	●	●	●
Boron Trifluoride	BF ₃	0-10.0 PPM	●	●	●	●	●	●
Bromine	Br ₂	0-2.0 PPM	●	●	●	●	●	●
Carbon Dioxide	CO ₂	0~5000 PPM	●	●	●	●	●	●
Carbon Dioxide	CO ₂	0 - 5.00%VOL	●	●	●	●	●	●
Carbon Dioxide	CO ₂	0~100% VOL	●	●	●	●	●	●
Carbon Monoxide	CO	0-100 PPM	●	●	●	●	●	●
Carbon Monoxide	CO	0-500 PPM	●	●	●	●	●	●
Chlorine	Cl ₂	0~5.0 PPM	●	●	●	●	●	●
Chlorine Dioxide	ClO ₂	0~5.0 PPM	●	●	●	●	●	●
Chlorine Trifluoride	ClF ₃	0-5.0 PPM	●	●	●	●	●	●
Diborane	B ₂ H ₆	0-1.0 PPM	●	●	●	●	●	●
Dichlorosilane	H ₂ SiCl ₂	0~10.0 PPM	●	●	●	●	●	●
Difluoromethane	CH ₂ F ₂	0~1000 PPM	●	●	●	●	●	●
Disilane	Si ₂ H ₆	0~20.0 PPM	●	●	●	●	●	●
Ethylene	C ₂ H ₄	0~10.0 PPM	●	●	●	●	●	●
Ethylene Oxide	ETO	0~10.0 PPM	●	●	●	●	●	●
Fluorine	F ₂	0 -5.0 ppm	●	●	●	●	●	●
Formaldehyde	CH ₂ O	0~10.0 PPM	●	●	●	●	●	●
Germane	GeH ₄	0~1.0 PPM	●	●	●	●	●	●
Helium	He	0~100% VOL	●	●	●	●	●	●
Hexafluoro butadiene	C ₆ F ₆	0~1,000 PPM	●	●	●	●	●	●
Hydrazine	N ₂ H ₄	0~2.0 PPM	●	●	●	●	●	●
Hydrogen (% LEL)	H ₂	0~100%LEL	●	●	●	●	●	●
Hydrogen (ppm)	H ₂	0~1000 PPM	●	●	●	●	●	●
Hydrocarbon(%LEL)	HC	0~100%LEL	●	●	●	●	●	●
Hydrocarbon(%LEL)	HC	0~100%LEL	●	●	●	●	●	●
Hydrogen Bromide	HBr	0~10.0 PPM	●	●	●	●	●	●
Hydrogen Chloride	HCL	0~10.0 PPM	●	●	●	●	●	●
Hydrogen Cyanide	HCN	0~20.0 PPM	●	●	●	●	●	●
Hydrogen Fluoride	HF	0~10.0 PPM	●	●	●	●	●	●
Hydrogen Selenide	H ₂ Se	0~5.0 PPM	●	●	●	●	●	●
Hydrogen Sulfide	H ₂ S	0~10.0 PPM	●	●	●	●	●	●
Methanethiol	CH ₃ S	0~20.0 PPM	●	●	●	●	●	●
Methyl Fluoride	CH ₃ F	0~1000 PPM	●	●	●	●	●	●
Nitrogen Dioxide	NO ₂	0~30.0 PPM	●	●	●	●	●	●
Nitrogen Oxide	NO	0~100PPM	●	●	●	●	●	●
Nitrogen Trifluoride	NF ₃	0~100 PPM	●	●	●	●	●	●
Nitrous oxide	N ₂ O	0~1000 PPM	●	●	●	●	●	●
Octafluorocyclobutane	C ₄ F ₈	0~1000 PPM	●	●	●	●	●	●
Octofluorocyclopentene	C ₅ F ₈	0~1000 PPM	●	●	●	●	●	●
Oxygen	O ₂	0~25.0 %VOL	●	●	●	●	●	●
Oxygen	O ₂	0~99.99 %VOL	●	●	●	●	●	●
Oxygen	O ₂	0~10000 PPM	●	●	●	●	●	●
Ozone	O ₃	0~5.00 PPM	●	●	●	●	●	●
Phosphine	PH ₃	0~5.00 PPM	●	●	●	●	●	●
Phosphorous Oxychloride	POCL ₃	0~1.00 PPM	●	●	●	●	●	●
Refrigerants	R290	0~100%LEL	●	●	●	●	●	●
Silane	SiH ₄	0~10.0 PPM	●	●	●	●	●	●
Sulfur Dioxide	SO ₂	0~20.0 PPM	●	●	●	●	●	●
Sulfur Hexafluoride	SF ₆	0~1000 PPM	●	●	●	●	●	●
Sulfur Tetrafluoride	SF ₆	0~1000 PPM	●	●	●	●	●	●
Tetrahydrothiophene	THT	0~100 PPM	●	●	●	●	●	●
Trimethyl Borate	TMB	0~500 PPM	●	●	●	●	●	●
Tetra Ethyl Ortho Silicate	TEOS	0~50.0 PPM	●	●	●	●	●	●
Tetrafluoromethane	CF ₄	0~2000 PPM	●	●	●	●	●	●
Trifluoro methane	CHF ₃	0~2000 PPM	●	●	●	●	●	●
Tungsten Hexafluoride	WF ₆	0~10.0 PPM	●	●	●	●	●	●
Vinyl Chloride	C ₂ H ₃ Cl	0~10.0 PPM	●	●	●	●	●	●
Volatile Organic Compounds	VOC	0~100 PPM	●	●	●	●	●	●
Volatile Organic Compounds	VOC	0~1000 PPM	●	●	●	●	●	●
Volatile Organic Compounds	VOC	0~5000 PPM	●	●	●	●	●	●

※ For other gases, Please inquire with us.

Standard Gas Measuring Instrument



CYLINDER

Gas Measuring Instrument



► Specification Combustible Standard Gas

Gas	Size	Concentration	Balance
CH4	34 Liter	2.5% (50%LEL)	AIR
H2		2% (50%LEL)	
I-C4H10(Butan)		0.9% (50%LEL)	
C3H8(Propane)		1.05% (50%LEL)	
I-C4H8(Isobutylene)		100ppm	

► Specification Toxic Standard Gas

Gas	Size	Concentration	Balance
NH3	34, 58 Liter	25~50ppm	N2
HCL		10ppm	
HCN		10ppm	
CO		30ppm	
SO2		10ppm	
CO2		25ppm	
NO2		10~50ppm	
NO		10~50ppm	
SIH4		5ppm	
PH3		0.5~5ppm	
C6H6		100ppm	
H2S		25ppm	
CL2		10ppm	
ETO	10ppm	HCL	

713

Combustible Gas Standard Regulator



► Specification

Classification	713
Size	34, 58 Liter
Demand Flow Rate	Flow rate 0.1 / 0.3 / 0.5
Maximum Inlet Pressure	500 psig/ 35 bar
Minimum Outlet Pressure	20 psig/ 1.4 bar
Inlet	CGA 600
Outlet	3/16" Barb/4.8mm
Gauge	0-500 psig/35bar

715

Toxic Gas Standard Regulator



► Specification

Classification	715
Size	34, 58 Liter
Demand Flow Rate	Flow rate 0.1 / 0.3 / 0.5
Maximum Inlet Pressure	1000 psig/ 70 bar
Minimum Outlet Pressure	60 psig/ 4.1 bar
Inlet	5/8-18 UNF
Outlet	3/16" Barb/4.8mm
Gauge	0-1000 psig/70bar



Fire Prevention Detector

MIR-64

Multi
Infrared Thermometer



* Dimension

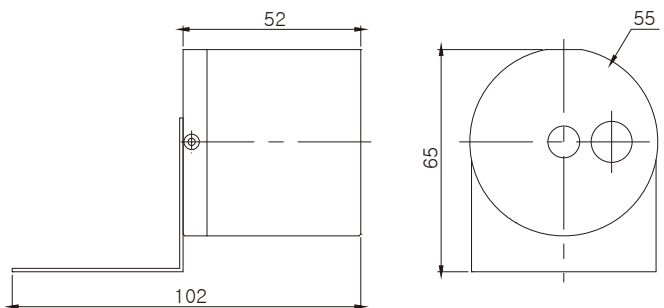

► Product Specification

Model no.	MIR-64
Power source	DC - 24V
Size	55 Ø x 52mm
Power consumption	0.84W
Temperature measuring range	-20℃~300℃
Measurement method	16x4 infrared temperature measurement (64 points)
Measuring cycle	0.5 Seconds
Error range	±1℃
Measurement range	60°x16° FOV
Relay output	SPST(NO)
Communication port	RS485x1

*Applications of MIR-64, MDI-64 products : Incoming panel & distribution board, ESS, High-voltage condenser, Panel board



Fire Prevention Detector



MDI-i

Infrared Thermometer
Indicator



* Dimension

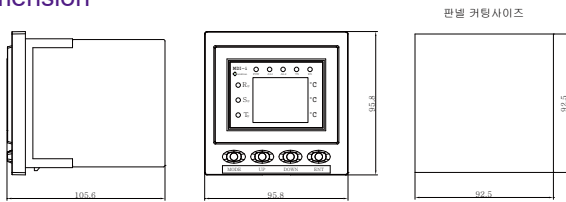

▶ Product Specification

Model no.	MDI-i
Power	AC 110V ~ 240V/60Hz
Display	TFT(160*128 dot)
RST Temperature Display	R HIGH,S HIGH,THIGH Temperature Display
Sensor supplied Power	MAX DC24V 500mA
Sensor Input Specification	RS-485(Modbus-RTU)
Sensor Communication Display	Tx,RX 표시 LED
RTS High Alarm Display	R,S,T 알람 LED
Alarm Value	AL1,AL2 알람 LED
Alarm	Channel -2 ALARM(A Contac)
	Connecto : AC250V/5A, DC30V 5A
External Communication Output	RS-485(Modbus-RTU)
Operating Temperature & Humidity	-20℃~60℃, 5~95% RH
	(Non-Condensing)
Power Consumption	3.5W
Weight	450g
Size	96(W) x 96(H) x 110(D)
Mounting method	PANEL Mounting Type
Cutting Dimension	92.5 x 92.5mm

MDI-64

Touchscreen Indicator



* Dimension

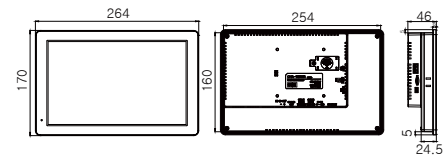

▶ Product Specification

Model no.	MDI-64
Power source	DC - 12~24V
Size	7-inch / 800mm x 480mm
Power Consumption	5W (0.4A@12V)
Communication Port	RS232x2, RS485x1, Ethernetx1
Case	Front waterproof type
Touch Method	Pressure sensitive type (resistive film type)
Sound	Speaker (voice file)
Ambient temperature during operation	-10℃~60℃
Storage Temperature	-20℃~70℃
Operating Humidity	5~95% RH (Non-Condensing)

Smoke Sensor

ASD-55

Smoke Sensor

CE



* Dimension

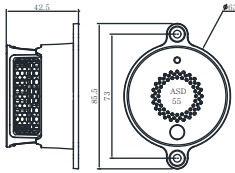

Product Specification

Model no.	ASD-55
Detection Principle	Dual Optical Smoke Sensor
Detection Method	Nonmetric Type
Response Time	within 3 sec
External Output	A Contac (DC 30 V 1 A), B Contac , RS485 MODBUS
Input Power	DC 22V~26V
Use Current	24V, 60mA(MAX)
External Housing	ABS
Operating temperature & Humidity	-35℃~80℃ / 0~95% RH(Non-condensing)
Process	AI Algorithm

ASD-56

Smoke Sensor

CE



* Dimension

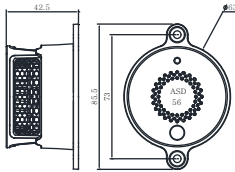

Product Specification

Model no.	ASD-56
Detection Principle	Dual Optical Smoke Sensor
Detection Method	Nonmetric Type
Response Time	within 3 sec
External Output	A Contact (DC 30 V 1 A), B Contact, RS485 MODBUS
Input Power	DC 22V~26V
Use Current	24V, 60mA(MAX)
External Housing	ABS
Operating temperature & Humidity	-35℃~80℃ / 0~95% RH(Non-condensing)
Process	AI Algorithm
Reset Switch	Return to normal after pressing the reset switch

ASD-57

Smoke Sensor

CE



* Dimension

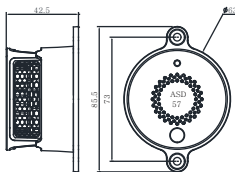

Product Specification

Model no.	ASD-57
Detection Principle	Dual Optical Smoke Sensor, thermistor sensor
Detection Method	Nonmetric Type or 70℃ 이상
Response Time	within 3 sec
External Output	A Contact (DC 30 V 1 A), B Contact , RS485 MODBUS
Input Power	DC 22V~26V
Use Current	24V, 60mA(MAX)
External Housing	ABS
Operating temperature & Humidity	-35℃~80℃ / 0~95% RH(Non-condensing)
Process	AI Algorithm
Reset Switch	Return to normal after pressing the reset switch

Temperature & Smoke Sensor



TS-60

Temperature & Smoke Sensor

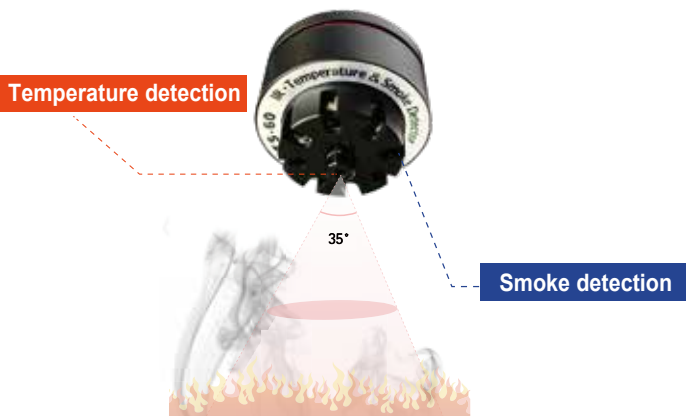

* Dimension

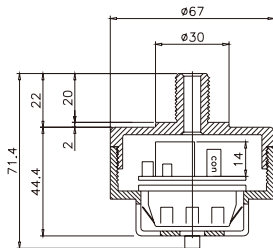

TS-70

Temperature & Smoke Sensor

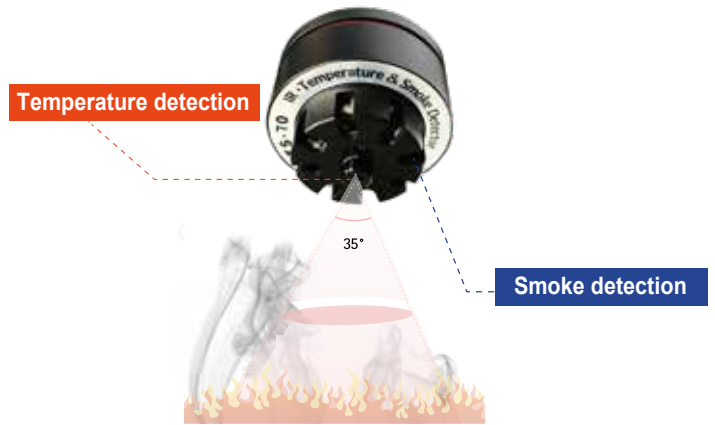

* Dimension

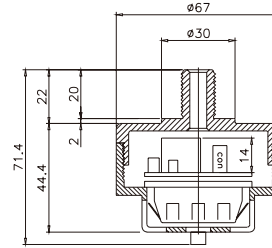

Product Specification

Model no.	TS-60_ Non contact Infrared thermometer
Measuring Range	-70 ~ 380°C (Alarm value setting by DIP switch)
Device	Thermopile (Non contact Infrared measurement)
Optical Resolution	35°
Optical Spectrum	8~14μm
Response time	0.3 sec
Relay Output	Relay A (DC30V 1A)

Model no.	TS-60_ Smoke sensor
Detection Principle	Ionizations Smoke Chamber
Detection Method	Diffusion
Response time	Within 3sec
Relay Output	Relay A (DC30V 1A)
Input power	DC 22V~26V
Current consumption	50mA. Maximum
Operation temperature / humidity	-20°C~ 60°C / 0 ~ 95% RH (Non-Condensing)
Process	Digital Process

- * Temperature setting in factory : 50°C
- * Smoke density : 1%

Product Specification

Model no.	TS-70_ Non contact Infrared thermometer
Measuring range	-70 ~ 350°C
Device	Thermopile (Non contact Infrared measurement)
Optical Resolution	35°
Optical Spectrum	8~14μm
Response time	0.3 sec
Relay Output	4-20mA

Model no.	TS-70_ Smoke sensor
Detection Principle	Ionizations Smoke Chamber
Detection Method	Diffusion
Response time	Within 3 sec
Relay Output	Relay A (DC30V 1A)
Input power	DC 22V~26V
Current consumption	50mA. Maximum
Operation temperature / humidity	-20°C~ 60°C / 0 ~ 95% RH (Non-Condensing)
Process	Digital Process

- * Temperature setting in factory : 50°C
- * Smoke density : 1%



Fixed Infrared Thermometer

*OEM Service is available, Please contact us for further information.

IR-100

High Temperature IR Thermometer



* Dimension

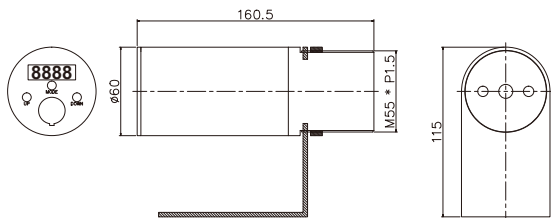

Product Specification

Model no.	IR-100
Power	DC24V
Power Consumption	6W
Analog Output	4-20mA
Digital Communication	RS-485
Display	LED 4digit green display
Emissivity	0.010~1.000
Response Speed t90	1ms
Accuracy	1℃ 또는 0.5%
Measuring Method	laser beam
Surrounding Temperature	0~75℃
Relative Humidity	95%RH(non-condensing)
Waterproof Rating	IP65
Weight	1.2kg
Material	SUS304

Code Number IR-100 -□-□

Model no.	Description
Code A	Temperature Range
1	1300℃~2400℃
2	500℃~1500℃
3	150℃~700℃
4	75℃~400℃
Z	Order specification temperature range
Code B	측정거리(A) 측정거리(S) 측정거리(A1) 측정거리 (S1)
1	250mm 9mm 530mm 16mm
2	200mm 4mm 600mm 13mm
3	86mm 1.8mm 200mm 15.5mm
Z	Separate order range

* Application :

Aluminum, Chrome, Copper, Metal, Magnesium, Oxidennickel, Platinum, Gold, Silver, Oxided-Titanium, Zinc, Tin, Steel, Oxided- Steel, Oxided-Brass, Etc.,

IR-90

Subminiature Non-contact infrared thermometer



* Free software



* Optical Field of View (80 :1)

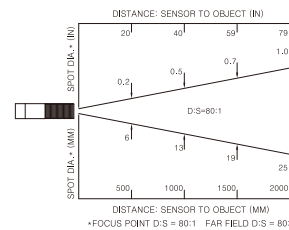

* Dimension

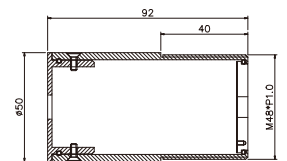

Product Specification

Model no.	IR-80
Range	150℃~700℃ 500℃~1700℃
Resolution	0.1℃
Emissivity	0.10~0.99
Response Time	Within 50msec
Accuracy	±1%/F.S or 1℃
Sensor	InGaAs, Silicon
Field of View (D:S)	100:1
Wavelength Range	0.85~1.1μm, 1~1.6μm, 2.0μm
Input Power	DC 20~24V (Max 50mA)
External Material	Aluminum
Cable	3m, other

Code Number IR-80-□-□-□

Model no.	Description
Code A	Temperature range
1	500℃~1500℃
2	800℃~2400℃
3	800~2200℃(Silicon sensor)
4	150~700℃ (Extend InGaAs 2.6um)
5	75℃~400℃
Z	Other
Code B	output
M	DC 0~20mA
N	DC 4~20mA
V	Voltage output DC 1~5V
Z	Other
Code C	Cable length
1	3M
Z	Other

* Application :

Aluminum, Chrome, Copper, Metal, Magnesium, Oxidennickel, Platinum, Gold, Silver, Oxided-Titanium, Zinc, Tin, Steel, Oxided- Steel, Oxided-Brass, Etc.,

Fixed Infrared Thermometer

*OEM Service is available, Please contact us for further information.



IR-View series

View Type Pyrometer



*Free software

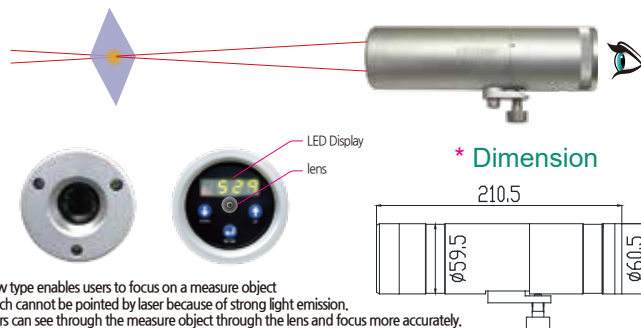

* Dimension

View type enables users to focus on a measure object which cannot be pointed by laser because of strong light emission. Users can see through the measure object through the lens and focus more accurately.

4-IRman

Non-Contact Infrared Thermometer



* Free software



* Optical Field of View (10:1)

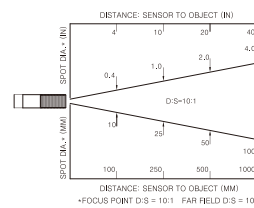

* Dimension

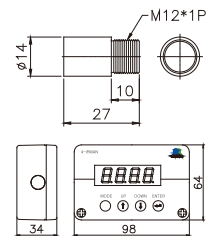

► Product Specification

Model no.	IR-View	
	1 color	2 color
Range	800°C~2400°C	
Resolution	1°C	
Emissivity	0.1~0.99	0.75~1.25
Response Time	Within 0.001sec	
Accuracy	±1%/F.S or 1°C	
Detection sensor	Si or InGaAs or 2 Color-Si/Si	
Field of view(D:S)	200:1	
Wave length Range	1.0μm, 1.1μm	
Input Power	DC 12~24V (Max 200mA)	
External Material	Aluminum	
Cable	3m, other	

► Model Number

Model	Temperature Range
1 Color	
IR-View-1	100~600°C
IR-View-4	400~1500°C
IR-View-8	800~2400°C
IR-View-10	1000~3000°C
2 Color	
IR-VIEW-2IG-3	300~700°C
IR-VIEW-SS-8	800~2400°C
IR-VIEW-SS-10	1000~3000°C

* Application :

Aluminium, Chrome, Copper, Magnesium, Nickel Oxide, Platinum, Gold, Silver, Titanium Oxide, Zinc, Tin, Steel, Etc.,

► Product Specification

Model no.	4-IRman
Range	-60~400°C
Resolution	0.1°C
Emissivity	0.10~1.00
Response Time	Within 100msec
Accuracy	±1%/F.S or 1°C
Field of view(D:S)	10:1
Wave length Range	8~14μm
Input Power	DC 20~24V (Max 200mA)
External Material	SUS
Cable	3m, other

► Code Number

4-IRman-□-□-□

Model	Description
Code A	Temperature range
1	-20~400°C
2	0~400°C
Z	Other
Code B	Output
N	DC 4~20mA
Z	Other
Code C	Cable length
1	3M
Z	Other

* Application :

Plastic, Lumber, Rubber, Glass, Paper, Asphalt, Ceramics, Food, Etc.,



Fixed Infrared Thermometer

*OEM Service is available, Please contact us for further information.

IR-22

Subminiature Non-Contact Infrared Thermometer

CE

* Free software



* Optical Field of View (10:1)

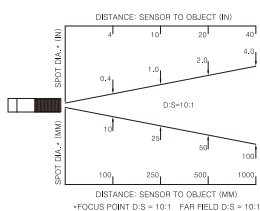

* Dimension

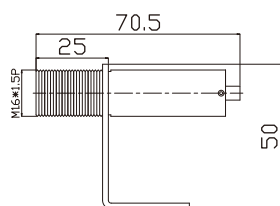

► Product Specification

Model no.	IR-22
Range	-60~380℃
Resolution	0.1℃
Emissivity	0.95 fixed (Changeable when using PC software program)
Response Time	Within 100msec
Accuracy	±1%/F.S or 1℃
Ambient temperature	-20~70℃
Field of View (D:S)	10:1
Wavelength Range	8~14μm
Input power	DC 12~24V (Max 50mA)
External Material	SUS
Cable	3m, other

► Code Number IR-22-□-□-□

Model	Description
Code A	Temperature range
1	0~200℃
2	0~350℃
3	-50~350℃
Z	Other
Code B	Output
M	DC 0~20mA
N	DC 4~20mA
V	DC 1~5V
Z	Other
Code C	Cable Length
1	1M
Z	Other

*Application :

Vinyl, Plastic, Lumber, Rubber, Glass, Paper, Asphalt Concrete, Oxidized Steel, Asphalt, Ceramics, Food, Etc.,

IR-Compact

Subminiature Non-Contact

CE RoHS

* Free software



* Optical Field of View (8:1)

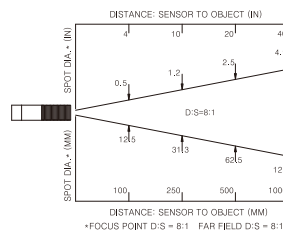

* Dimension

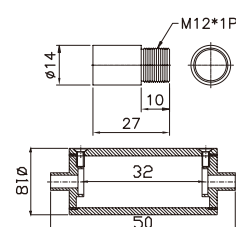

► Product Specification

Model no.	IR-Compact
Range	-60~380℃
Resolution	0.1℃
Emissivity	0.10~0.99
Response Time	Within 100msec
Accuracy	±1%/F.S or 1℃
Ambient temperature	-30~85℃
Field of View (D:S)	8:1
Wavelength Range	8~14μm
Input Power	DC 12~24V (Max 200mA)
External Material	SUS
Waterproof	IP65, NEMA 4
Cable	3m, other

► Code Number IR-Compact-□-□-□-□

Model	Description
Code A	D:S
1	8:1
2	12:1 (Option)
Code B	Temperature Range
1	0~350℃
2	-60~350℃
Z	Other
Code C	Output
N	DC 4~20mA
Code D	Cable length
1	1M
Z	Other

*Application :

Vinyl, Plastic, Lumber, Rubber, Glass, Paper, Asphalt Concrete, Oxidized Steel, Asphalt, Ceramics, Food, Etc.,

Fixed Infrared Thermometer

*OEM Service is available, Please contact us for further information.



IR-40

Non-Contact
Infrared Thermometer

CE



*Free software



* Optical Field of View (40:1)

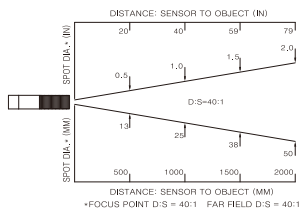

* Dimension

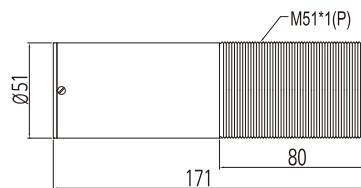

► Product Specification

Model no.	IR-40
Range	0°C~1,000°C
Resolution	0.1°C
Emissivity	0.1~0.99
Response Time	Within 100msec
Accuracy	±1%/F.S or 1°C
Detection Sensor	Thermopile
Field of View (D:S)	40:1
Wavelength Range	8~14μm
Input Power	DC 20~24V (Max 50mA)
External Material	Aluminum
Cable	3m, other

► Code Number

IR-40-□-□-□

Model	Description
Code A	Temperature range
1	0°C~1000°C
2	0°C~700°C
3	-20°C~1000°C
Z	Other
Code B	Output
M	DC 0~20mA
N	DC 4~20mA
V	Voltage output DC 1~5V
Z	Other
Code C	Cable length
1	3M
Z	Other

* Application :

Vinyl, Plastic, Lumber, Rubber, Glass, Paper, Asphalt Concrete, Oxidized Steel, Asphalt, Ceramics, Food, Etc.,

Infrared Thermometer Accessories

Options



Bracket



Airpurge



Water-cooling jacket



Laser pointer

Indicator

DA-90

Large Size Indicator



* Dimension

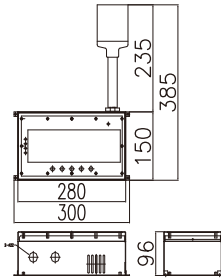

IR-I

Infrared Thermometer Indicator



* Dimension

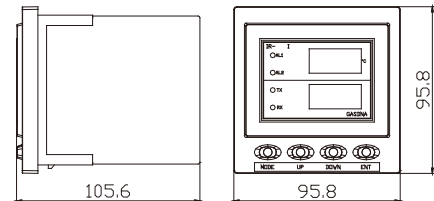

► Product Specification

Model no.	DA-90
Structure	Single type / 1 Circuit
Display	Large size FND 5 DIGIT(2.3 Inch)
Input Power	AC 230V/60Hz
Input signal	4-20mA DC/F.S
Output Power	DC 24V(750mA)
Output Signal	4-20mA DC/F.S
Alarm Display	Low alarm - AL1 LED (Red)
	High alarm - AL2 LED (Red)
	Fault alarm - Fault LED (Yellow)
Alarm Type	Visual : LED Flickering
	Auditory : Buzzer sound (More than 80 dB)
Alarm Value Setting	AL1/AL2 2 Level alarm (Adjustable by user)
Alarm Delay Time	0 sec ~ 99 sec (Adjustable by user)
Alarm Off	Manual, Automatic return
Alarm Output	2step(AL-1/AL-2) Alarm RELAY CONTACT, RS-485(Optional)
Operating Temperature /Humidity	-10°C ~ 60°C , 5 ~ 95%RH (Non-Condensing)
Installation Method	Wall Mounting

► Product Specification

Model no.	IR-I
Input	DC(4~20mA) or RS-485(Baudrate 9,600bps)
Accuracy	≤ ± 0.2%Full Scale
Dimensions and Display Cycle	100 ms
Sensor Power	DC 24V 50mA
Display	T.Value(4 DIGT), Emissivity(4 DIGT)
Relay Output	4~20mA/Full Scale
	RS485 (Baudrate : 4,800~ 57,600bps)
Input Power	AC 110V ~ 240V/60Hz
Power Consumption	3.5W
Weight	450g
Size (mm)	96(W) x 96(H) x 110(D) mm

Indicator



GMS-1600



* Dimension

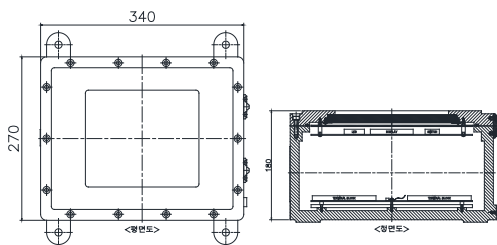

▶ Product Specification

Model no.	GMS-1600
Mounting	Wall mounting
Connecting to detector	Multi-point type(max connectable detectors - 4 units)/4 circuits
Input Power	AC 220 V / 60 Hz, AC 110 V / 60 Hz
Input Signal	4 Channels (4~20mA / FS)
Output Power	DC 24V(250mA)
Output Signal	4 Channels (4~20mA / FS)
Density Indication	LCD Display - PPM, %LEL, % set by user
Alarm Indication	Low alarm - AL1 LED (Red) High alarm - AL2 LED (Red) Fault alarm - Fault LED (Yellow)
Alarm Method	Optical - LED blinking Sonic - Buzz sound (higher than 80dB)
Set Alarm Value	HIGH/LOW 2 step alarm set by user
Alarm Delay Time	0~99 seconds set by use
Alarm Release	Manual or automatic release
Alarm Output	250 V 5 A / 11-SPST Relay-Contact(10 Alarms, 1 Fault)
Operation Temperature	-10℃ ~ 50℃
Operation Humidity	5~95%RH (Non-Condensing)

Portable Infrared Thermometer

*OEM Service is available, Please contact us for further information.

PIR-80

Portable Infrared Thermometer



Product Specification

Model no.	PIR-80
Range	800 ~ 1700°C
Operating Temperature	0~50°C
Accuracy	±1%
Emissivity	0.95(Fix)
Response Time	0.05 sec
Field of View (D:S)	100:1
Chargeable Indicator : LED	Battery voltage : Below 3.5V
Battery level	3.7V 2600mA
charging system	Overcharge V:4.2 V, Overcharge V:2.5 V, Overcurrent A:3A
Battery life	Min 40 hours continuous use
Dimensions	80 x 180 x 190mm(WxDxH)
Weight	1200g (with the Battery)

PIR-1500

Portable Infrared Thermometer



Product Specification

Model no.	PIR-1500
Range	-35°C~1500°C
Wavelength Range	8~14μm
Operating Temperature	0~50°C
Accuracy	2°C or ±2%
Emissivity	0.1~1.0
Response Time	within 1 Sec.
Field of View (D:S)	75:1
Memory	Detailed 24 Memories with Temperature & Emissivity
Battery life	min 14 hours continuous use (without Laser and Back Light)
Dimensions	204.14*179.19*58.40mm
Weight	355g(including battery)

PIR-550

Portable Infrared Thermometer



Product Specification

Model no.	PIR-550
Range	-60°C~550°C
Wavelength Range	8~14μm
Operating Temperature	0~50°C
Accuracy	2°C or ±2%
Emissivity	0.1~1.0
Response Time	within 1 Sec.
Field of View (D:S)	12:1
Battery life	min 14 hours continuous use
Dimensions	143.9*116.73*42.78mm
Weight	180g(including battery)

Leak Sensor



LD-20

Leak Sensor



* Dimension

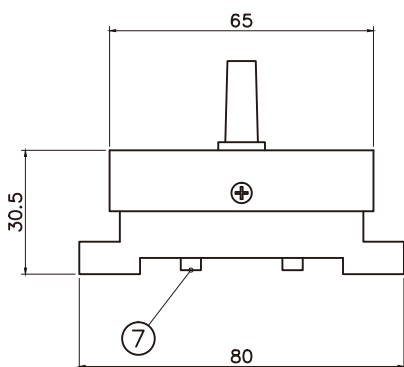

▶ Product Specification

Model no.	LD-20
Installation Place	Buildings where chemical solutions are stored, Around tanks, underneath chemical transmission pipes, and other chemical leaks.
Power	DC20~28V
Current Consumption	DC24V 70mA(Max)
Operation Indication	Power Operation Indication: Green LED lights up Liquid Leak Detection Indication: RED LED flashing light Normal Operation Indication: RED LED turns off
Alarm Hearing	buzzer sound over 85 dB
Alarm Remove	Reset button
Alarm Output	NPN TR Output/Relay Contact(a,b Contact)
Housing	PET,SUS304
Waterproof	Silicone Molding
Operating temperature	-10~50℃
Operating Humidity	5~95 %RH(Non-Condensing)

Certificate Status

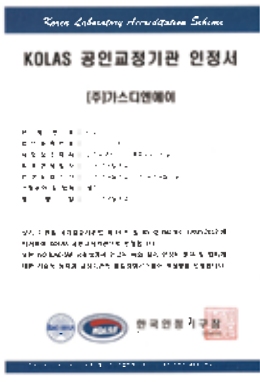

* KOLAS Accredited Calibration Institution Certificate



* ISO9001-14001 Quality Environment



* Innobiz Certificate



* Venture Business Certificate



* MIR-64 Patent Certificate



* Patent- Non-Contact Temperature Measuring Device



* Patent -Secondary Battery Leak Inspection Device



* DA-100 IECEX International Explosion Proof Certificate



* DA-100 Explosion Proof Certificate



* DA-500 Explosion Proof Certificate



* DA-600 IECEX International Explosion Proof Certificate



* DA-800 Explosion Proof Certificate

Certificate Status



* DA-100 KR Korean Shipping Certificate



* DA-500 KR Shipping Certificate



* ATEX DA-100 Certificate



* ATEX_DA-600 Certificate



* ASD-55 (56,57) CE



* DA-50 CE Certificate



* DA-750 CE Certificate



* IR-20 CE Certificate



* IR-80 CE Certificate



* SD-51 CE Certificate

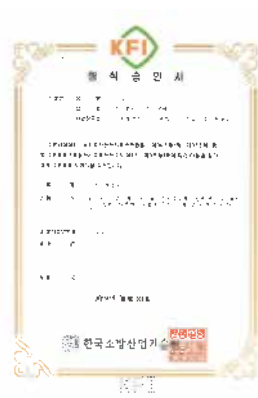

* Approval Type(Ga 19-9)



* Approval Type(가20-4)



101, Bukhang-ro 193beon-gil, Seo-gu, Incheon, 22856, Republic of Korea
TEL: +82-32-623-7507 FAX: +82-32-623-7510 E-mail: sales@gasdna.com

<http://www.gasdna.com>